

RESIDENTIAL PROPERTY RECORD CARD

Date Printed 05/03/24

Owner Information

Parcel **R11006**
 Owner **PLUMER JOHN EST**
C/O LARRY PLUMER
 55 CENTER STREET
 BYFIELD, MA 01922
 Location **1569 VT ROUTE 102**
 Descr: **LAND & DWELLING**

Parcel Value Information

Land Value	18,000	Homestead	62,800
Dwelling Value	29,800	Housesite	62,800
Site Imprvmt	15,000		
Outbuildings	0		
Misc. Adj.	0		
Total	62,800		

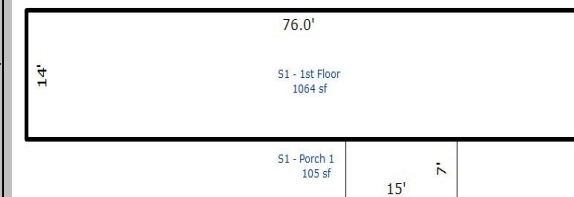

Parcel Information

Tax Map #	R11006.	NBHD	5
Span	126-039-10683	Acres	0.80
Status	A - Active	Last Update	01/25/22

Sales Information

Book	63	Sale Date	10/29/15
Page	369	Sale Price	44,000



Sketch Updated: 10/11/21

BUILDING	Total Rooms	5	Year Built	1995	Building SF	1064	Energy Adj	Average	Roughins	1
	Bedrooms	3	Effect Age	27	Quality	3.00	Bsmt Wall	NoData	Plumb Fixt	8
	Full Baths	2	Condition	Fair/Avg	Style	1 Story	Bsmt SF	0.00	Fireplaces	0
	Half Baths	0	Phys Depr	37	Design	MobileHo	Bsmt Fin	No Data	Porch	105
	Kitchens	1	Funct Depr	0	Bldg Type	Mobile	Bsmt Fin SF	0	Gar/Shed	0
			Econ Depr	0					% Complete:	0

INSPECT	INSP.	Complete	INSP.	Left Card	INSP.	Reapprais	APPT	NoData	APPTSCHD
----------------	-------	-----------------	-------	------------------	-------	------------------	------	---------------	----------

NOTES